

SPECIFICATIONS

Current Rating: 5Amps
 Contact Resistance: 30m Ω Max
 Insulation Resistance: 1000M Ω Min
 Withstanding Voltage: 500V AC for 1 minute
 Temperature Range: -55°C to +105°C

MATERIAL

Contact: Brass
 Insulator: PBT+30% G.F., UL94V-0
 Shell: SPCC

ORDER INFORMATION

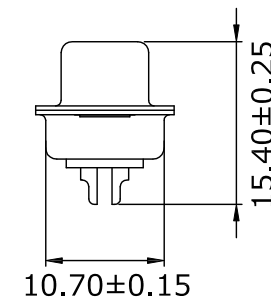
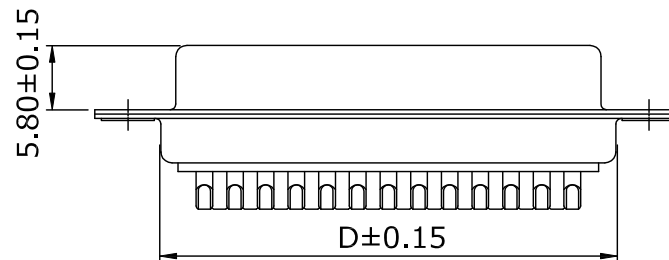
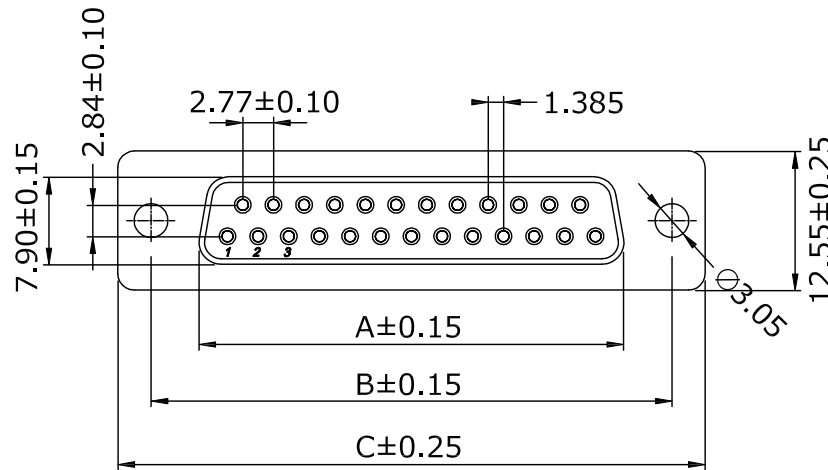
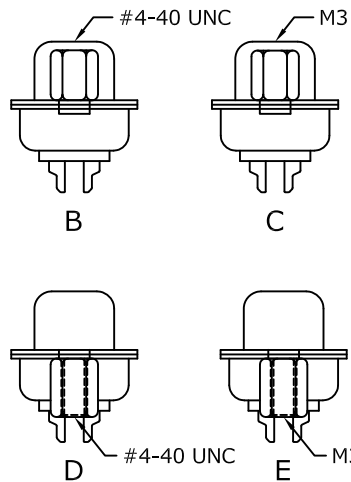
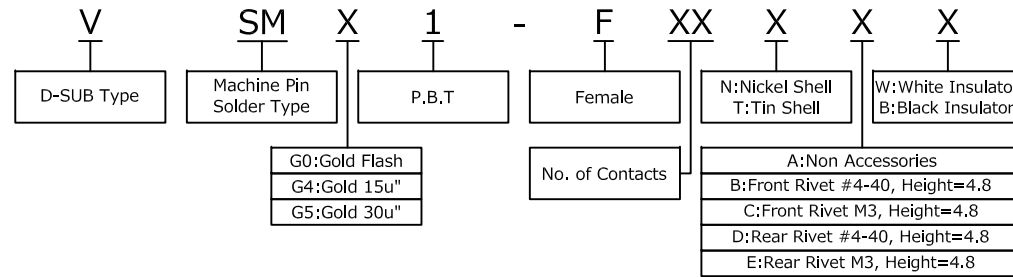

No. of contact	Dimensions			
	A	B	C	D
09	16.33	24.99	30.81	19.20
15	24.80	33.32	39.20	27.70
25	38.38	47.04	53.04	41.10
37	54.84	63.50	69.40	57.30



PART NO.	VSMX1-FXXXXX	DRAWN	Andrew
DRAWING NO.	VSMX1-FXXXXX	CHECKED	Claudia
DATE	2024/01/12	APPROVED	Brian

TITLE:	D-SUB Machine Pin solder type	REV.	A0	TOLERANCE	.X ±0.25 .XX ±0.20	SCALE	1:1	UNIT	mm
--------	-------------------------------	------	----	-----------	-----------------------	-------	-----	------	----